

- (A) New independent structure to support mezzanine floor. Indicative structure shown in red
- (B) Floor to be structurally upgraded locally if required to accommodate additional loading from mezzanine. Investigative works to be carried out to confirm extent of works.
- (C) New compartment walls to be formed to divide hall in two separate flats.
- (D) Low level timber paneling to be boxed out.
- (E) Existing Fire places to be left exposed
- (F) Refer to detail for proposed junction. between old and new. Detail A

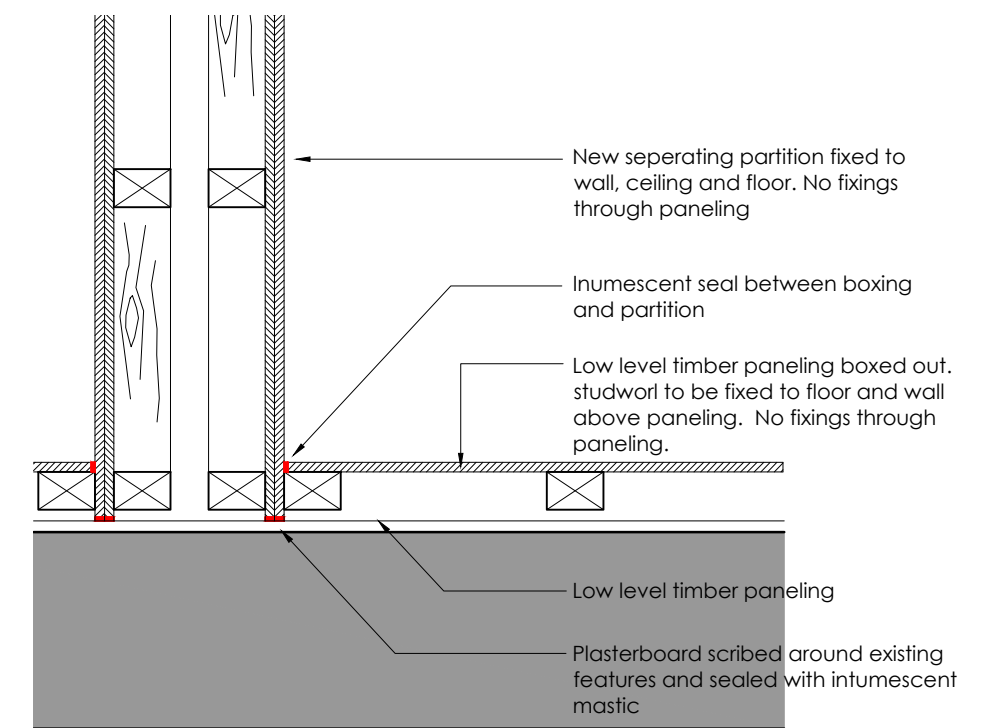

Detail A

Conversion 16 Charles Street, Newport.	Job No. 17_071	Rev.
	Dwg No. AL(00)13	
Title Main hall diagram		
Date 17.08.17	Drawn	Scale 1:50 @ A3
 Architects · Town planners Environmental & Urban design		
Unit 1A, Compass Business Park, Pacific Road, Cardiff, CF24 6HL		www.cjarchitects.co.uk tel: 029 20452100