

Landscape Strategy

The proposals aim to repair and conserve as much of the existing paving as possible. Where the Pavilion building has been reduced in extents to the west, reclaimed yorkstone will be used to match existing.

All yorkstone has been recommended to be relaid with smaller mortar joints with lime mortar. The yorkstone around the bricks to the English Garden will be retained in situ and the bricks are to be cleaned to protect them.

Reclaimed terracotta tiles are proposed to the Spanish Garden Loggia to recreate the original design intent. The Loggia yorkstone step treads are proposed to be lifted, cleaned of yellow hazard paint, and replaced by bronze metal strip nosings recessed and epoxied in place. Decorative tiles are proposed to the step risers to tie in with central quadrant. The new steps will be designed to match.

New sustainable bamboo timber decking is proposed to float over the stream pond, and used for the bridges, being dark in colour like the original bridge.

LEGEND

- Existing Paving to be cleaned in-situ (347m²)
- Existing Paving to be lifted, cleaned and relaid to match existing (390m²)
- Proposed reclaimed terracotta tiles (39m²)
- Renovated Existing Steps
- Proposed steps to match renovated steps
- Existing yorkstone to be lifted, cleaned, and re-laid with narrow mortar joints. Where extra paving is required, reclaimed yorkstone to match. (660m²)
- Bamboo timber decking (28m²)
- Edge of existing paving/ building

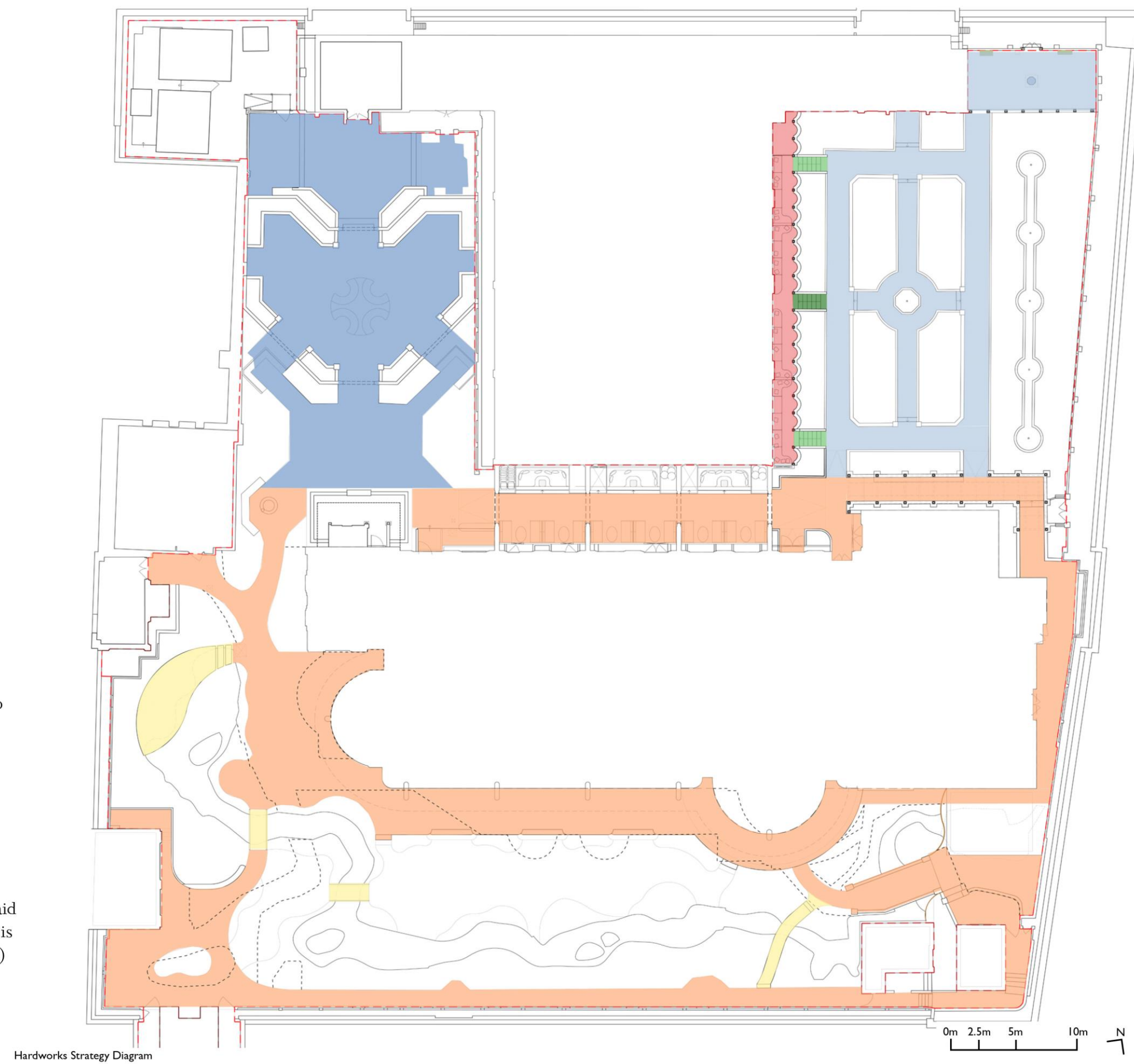

Due to loading and hoist access restrictions, the trees will be limited in size.

All multi-stem trees are proposed to be between:

- 150-175cm height will have a weight of 135kg;
- 300-350cm height will have a weight of 550kg;

The species have been selected to provide seasonal interest (blossom and strong autumn colour), provide berries for biodiversity, evergreen species for winter greening and screening, and to tie in with the original species, as well as select species suitable for climate resilience.

Please refer to Tree Plan and Schedules for further information.



Due to loading restrictions we have to balance the removal and replacement of trees, so are limited on the additional trees we can plant. However, we have proposed 22no. new trees to replace the 14no. to be removed.

We have retained the palms in the Spanish Garden.

Within the Woodland Garden, the proposed trees aim to link the existing trees through inter-planting with multi-stems of Amelanchier providing beautiful autumnal colour, fruits, and mid level habitat structure for fauna.

To the eastern end of the garden we have replaced the stressed fruit trees with Prunus multi-stem trees providing stunning spring blossom and fruit.

In the English Garden, two new multi-stems are proposed to frame the Tudor arches and walls, with a feature tree at its centre, and espalier fruiting trees grown up the sheltered south facing walls.

LEGEND

- Site boundary - extent of landscape works
- Trees to be retained
- Prunus yedoensis (5no.)
- Osmanthus heterophyllus (2no.)
- Amelanchier lamarckii (7no.)
- Heptacodium miconioides (2no.)
- Diospyros lotus (2no.)
- Espalier Malus domestica & Pyrus communis (4no.)



The planting strategy has been developed to reinforce the character of each of the gardens. The English Garden seeks to be more formal, comprising of more evergreen species, in green and white tones, with beds brimming with climbers scaling the heritage walls, and pot planting offering seasonal interest.

The Spanish Garden is proposed to be a Mediterranean mix of drought tolerant more arid style of plants, with strong coloured highlights within the planting mix.

The Woodland Garden is a contemporary take on an English garden, with a more pastel colour palette, mix of grasses, perennials, and shade tolerant planting for under the existing trees. A species rich lawn provides valuable amenity space, whilst enhancing biodiversity, and all garden walls will be laced with fragrant native climbers.

Pot plants and internal planting will help bring the garden inside, and soften the paved terraces. Biodiverse green roofs and living walls, add to the vertical greening.

LEGEND

- Green Roof
- Lawn
- Perennial / Herbaceous Planting
- Climbers
- Shrubs
- Pot Plants

